

Technical information about mounting brackets K2093



Installing and removing the clamping arm:

Four angle lengths can be used either individually or combined, to cover all rail lengths. To determine the number of bracket sets required, see the table below. The supplied screws do not fit rail K1717. We recommend using M6 countersunk head screws.

Article no.	-305		-406		-559		-711	
	S	B	S	B	S	B	S	B
K1719.03050	1	2						
K1719.03051	1	2						
K1719.03560	1	2						
K1719.03561	1	2						
K1719.04060			1	2				
K1719.04061			1	2				
K1719.04570			1	2				
K1719.04571			1	2				
K1719.05080			1	2				
K1719.05081			1	2				
K1719.05590					1	2		
K1719.05591					1	2		
K1719.06100					1	2		
K1719.06101					1	2		
K1719.06600					1	2		
K1719.06601					1	2		
K1719.07110							1	2
K1719.07111							1	2
K1719.07620							1	2
K1719.07621							1	2
K1719.08130							1	2
K1719.08131							1	
K1719.08640	2	4						
K1719.08641	2	4						
K1719.09140	2	4						
K1719.09141	2	4						
K1719.10160	1	3			1	1		
K1719.10161	1	3			1	1		
K1719.10670	1	3					1	1
K1719.10671	1	3					1	1
K1719.12190	1	3					1	1
K1719.12191	1	3					1	1
K1719.13720		1		1	2	2		
K1719.13721		1		1	2	2		
K1719.15240					1	3	1	1
K1719.15241					1	3	1	1

Technical information about mounting brackets K2093



Article no.	-305		-406		-559		-711	
	S	B	S	B	S	B	S	B
K1720.0254								
K1720.0305	1	2						
K1720.0356	1	2						
K1720.0406			1	2				
K1720.0457			1	2				
K1720.0508			1	2				
K1720.0559					1	2		
K1720.0610					1	2		
K1720.0660					1	2		
K1720.0711							1	2
K1720.0762							1	2
K1720.0813							1	2
K1720.0864	2	4						
K1720.0914	2	4						
K1720.1016	1	2			1	2		
K1720.1067	1	2				1	1	1
K1720.1118	1	2			1	2		
K1720.1220	1	2					1	2
K1720.1372				1	2	3		
K1720.1524					1	2	1	2
K1717.0305	1	2						
K1717.0356	1	2						
K1717.0407			1	2				
K1717.0457			1	2				
K1717.0508			1	2				
K1717.0559					1	2		
K1717.0610					1	2		
K1717.0660					1	2		
K1717.0711							1	2
K1717.0762							1	2
K1717.0813							1	2
K1717.0864		2					1	1
K1717.0914	1	3	1	1				

S = Side mounting

B = Mounting from below

Technical information about mounting brackets K2093



Side mounting:

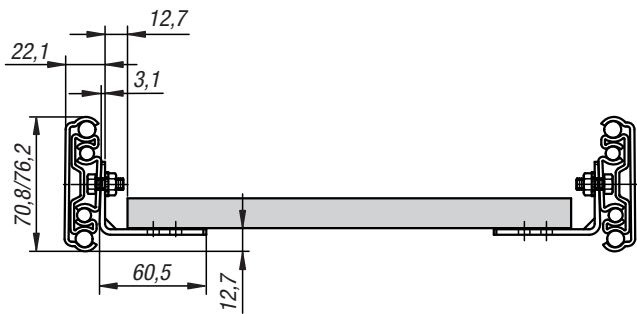

Mounting from below:

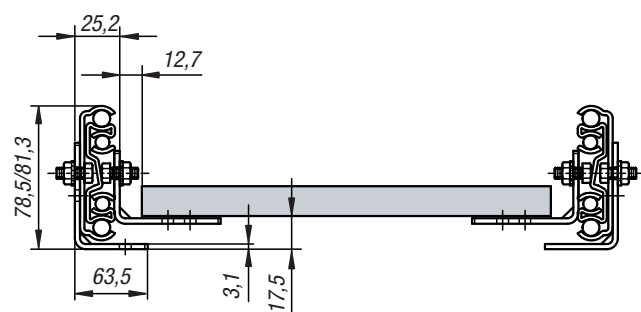
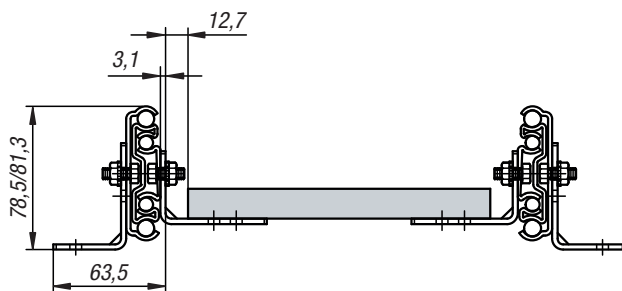
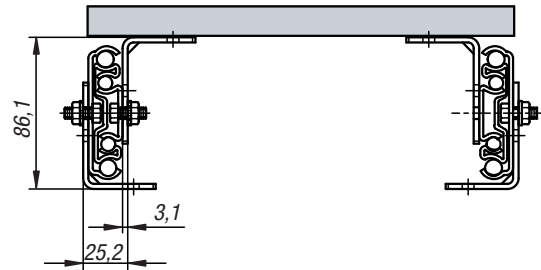
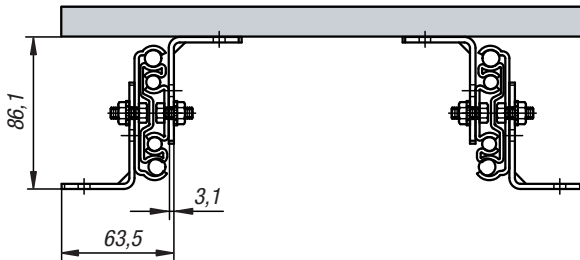

Technical information about mounting brackets K2093



Mounting bracket, steel, for telescopic slides

Mounting bracket	Image	IM/OM:	Telescoping Rail:
K2093.0305		IM	K1720.0305 K1719.03050 K1719.03051
K2093.0305		OM	K1720.0305 K1719.03050 K1719.03051
K2093.0305		IM	K1720.0356 K1719.03560 K1719.03561
K2093.0305		OM	K1720.0356 K1719.03560 K1719.03561
K2093.0406		IM	K1720.0406 K1719.04060 K1719.04061
K2093.0406		OM	K1720.0406 K1719.04060 K1719.04061
K2093.0406		IM	K1720.0457 K1719.04570 K1719.04571
K2093.0406		OM	K1720.0457 K1719.04570 K1719.04571
K2093.0406		IM	K1720.0508 K1719.05080 K1719.05081
K2093.0406		OM	K1720.0508 K1719.05080 K1719.05081
K2093.0559		IM	K1720.0559 K1719.05590 K1719.05591
K2093.0559		OM	K1720.0559 K1719.05590 K1719.05591
K2093.0559		IM	K1720.0610 K1719.06100 K1719.06101
K2093.0559		OM	K1720.0610 K1719.06100 K1719.06101
K2093.0559		IM	K1720.0660 K1719.06600 K1719.06601
K2093.0559		OM	K1720.0660 K1719.06600 K1719.06601
K2093.0711		IM	K1720.0711 K1719.07110 K1719.07111
K2093.0711		OM	K1720.0711 K1719.07110 K1719.07111
K2093.0711		IM	K1720.0762 K1719.07620 K1719.07621

Technical information about mounting brackets K2093



Mounting bracket, steel, for telescopic slides

Mounting bracket	Image	IM/OM:	Telescoping Rail:
K2093.0711		OM	K1720.0762 K1719.07620 K1719.07621
K2093.0711		IM	K1720.0813 K1719.08130 K1719.08131
K2093.0711		OM	K1720.0813 K1719.08130 K1719.08131
2x K2093.0305		IM	K1720.0864
2x K2093.0305		IM	K1719.08640 K1719.08641
2x K2093.0305		OM	K1720.0864 K1719.08640 K1719.08641
2x K2093.0305		IM	K1720.0914 K1719.09140 K1719.09141
2x K2093.0305		OM	K1720.0914 K1719.09140 K1719.09141
1x K2093.0305 + 1x K2093.0559		IM	K1719.10160 K1719.10161 K1720.1016
1x K2093.0305 + 1x K2093.0559		OM	K1720.1016
2x K2093.0305		OM	K1719.10160 K1719.10161
1x K2093.0305 + 1x K2093.0711		IM	K1720.1067 K1719.10670 K1719.10671
1x K2093.0305 + 1x K2093.0559		OM	K1720.1067
2x K2093.0305		OM	K1719.10670 K1719.10671
1x K2093.0305 + 1x K2093.0559		IM	K1720.1118
1x K2093.0305 + 1x K2093.0559		OM	K1720.1118
1x K2093.0305 + 1x K2093.0711		IM	K1720.1220 K1719.12190 K1719.12191/
1x K2093.0305 + 1x K2093.0711		OM	K1720.1220
2x K2093.0305		OM	K1719.12190 K1719.12191

Technical information about mounting brackets K2093



Mounting bracket, steel, for telescopic slides

Mounting bracket	Image	IM/OM:	Telescoping Rail:
1x K2093.0559 + 1x K2093.0406		OM	K1720.1372
2x K2093.0559		IM	K1720.1372 K1719.13720 K1719.13721
1x K2093.0305 + 1x K2093.0406		OM	K1719.13720 K1719.13721
1x K2093.0559 + 1x K2093.0711		IM	K1720.1524 K1719.15240 K1719.15241
1x K2093.0559 + 1x K2093.0711		OM	K1720.1524
2x K2093.0559		OM	K1719.15240 K1719.15241

IM = Inner rail
OM = outer rail