

Traction sleeves with inner tube

Item description/product images



Description

Material:
Steel.

Version:
Plastic coated.

Note:
The traction sleeve with inner tube is a replacement part for the indexing plungers with remote actuation K1502.

On request:
Special lengths.

Accessory:
Wire cable with ball K2023.
End sleeve K2025.
Setscrew K2026.
Screw nipple K2027.
Hex nut K0700.

Drawings

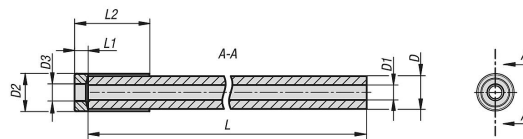

Overview of items

Traction sleeves with inner tube

Order No.	Main material	Surface finish body	D	D1	D2	D3	L	L1	L2
K2024.0150X1000	steel	plastic-coated	5	2,2	5,5	2,5	1000	2	11
K2024.0150X3000	steel	plastic-coated	5	2,2	5,5	2,5	3000	2	11
K2024.0150X5000	steel	plastic-coated	5	2,2	5,5	2,5	5000	2	11