

## Clamping cams

### Item description/product images

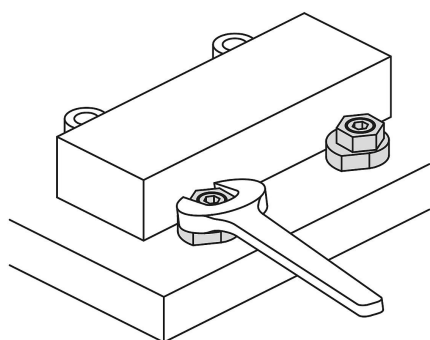
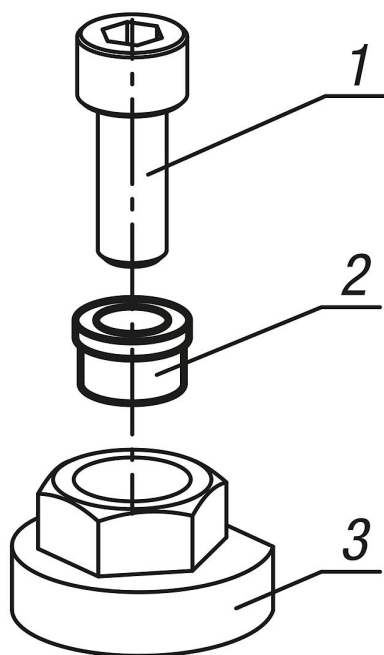

### Description

**Material:**

Carbon steel.

**Version:**

Black oxidised.

**Assembly:**

1. Screw the locking screw into the collar bush and fixture clamp and screw onto the baseplate.
2. The workpiece is clamped by tightening the fixture clamp with a spanner.

**Advantages:**

- Compact design
- Quick and easy clamping of components

**Drawing reference:**

- 1) Locking screw
- 2) Collar bush
- 3) Fixture clamp

## Clamping cams

### Drawings

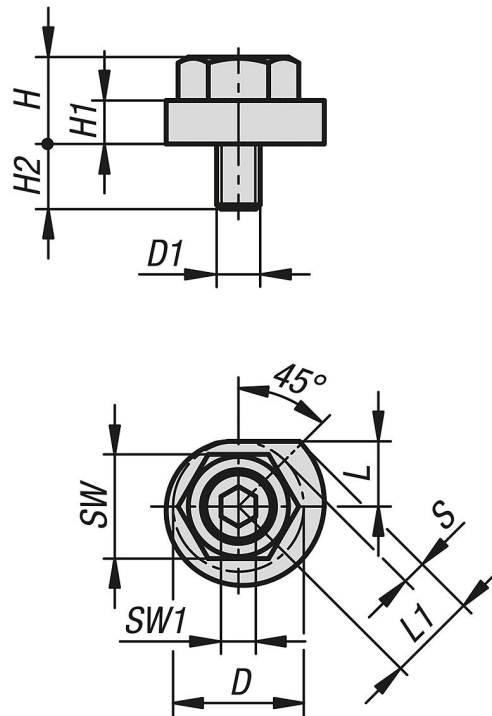

### Overview of items

#### Clamping cams

Order No.	D	D1	H	H1	H2	L	L1	SW	SW1	Clamping force kN	Travel S	Tightening torque max. Nm
<b>K1694.08</b>	24	M8	16	8	12	12	16,4	19	6	5,2	4,4	50
<b>K1694.10</b>	30	M10	20	10	15	15	20,5	24	8	8	5,5	75
<b>K1694.12</b>	34	M12	24	12	18	17	23,2	27	10	9,3	6,2	90