

## Linear actuators, stainless steel

### Item description/product images



### Description

#### Material:

DIN EN 10305 precision tube, stainless steel 1.4301.

Trapezoidal thread spindle, right-hand thread, rolled, stainless steel 1.4301.

#### Note:

Medium speed range, self-locking.

Travel  $S = \text{Length } L - (2 \times L2 + J)$ .

#### On request:

Left-hand thread, 2 drive cones, other travels or handwheels.

#### Accessory:

- Guides, stainless steel, K0496, K0498, K0499
- Clamping elements of the tubular connection system

#### Functional principle:

A rotating movement of the threaded spindle is converted into a linear movement of the guide carriage.

### Drawings

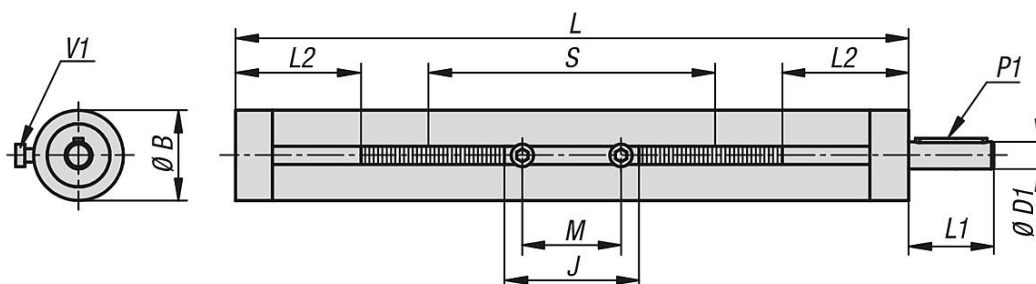

### Overview of items

#### Linear actuators, stainless steel

Order No.	Version 1	Type E	Spindle	L	Travel S	B	D1	J	L1	L2	M	P1 parallel key DIN 6885	V1
K0495.1300101X300	with ball bearing	30	Tr 14x3	300	109	30	8 h8	31	26	80	22	2 x 2 x 20	M4x8
K0495.1300101X500	with ball bearing	30	Tr 14x3	500	309	30	8 h8	31	26	80	22	2 x 2 x 20	M4x8
K0495.1300101X800	with ball bearing	30	Tr 14x3	800	609	30	8 h8	31	26	80	22	2 x 2 x 20	M4x8
K0495.1400101X300	with ball bearing	40	Tr 20x4	300	107	40	12 h8	39	38	77	28	4 x 4 x 32	M6x10
K0495.1400101X500	with ball bearing	40	Tr 20x4	500	307	40	12 h8	39	38	77	28	4 x 4 x 32	M6x10
K0495.1400101X800	with ball bearing	40	Tr 20x4	800	607	40	12 h8	39	38	77	28	4 x 4 x 32	M6x10
K0495.1400101X1000	with ball bearing	40	Tr 20x4	1000	807	40	12 h8	39	38	77	28	4 x 4 x 32	M6x10

