

## Five lobe grips with internal thread

### Item description/product images



### Description

#### Material:

Thermoset PF 31.  
Steel or stainless steel.

#### Version:

Thermoset black, high-gloss polished.  
Trivalent blue passivated steel or bright stainless steel.

### Drawings

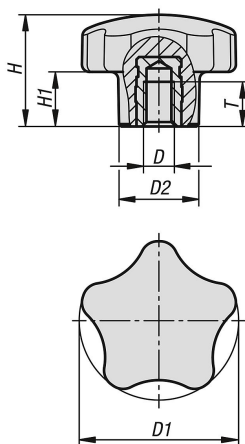

### Overview of items

#### Five lobe grips with internal thread

Order No.	Component material	D	D1	D2	H	H1	T
K1297.3205	steel	M5	32	16	22,5	11	7,5
K1297.3206	steel	M6	32	16	22,5	11	9
K1297.4006	steel	M6	40	20	28	14	9
K1297.4008	steel	M8	40	20	28	14	12
K1297.4010	steel	M10	40	20	28	14	15
K1297.5008	steel	M8	50	25	35	17,5	12
K1297.5010	steel	M10	50	25	35	17,5	15
K1297.6012	steel	M12	60	30	37	18,5	18
K1297.13205	stainless steel	M5	32	16	22,5	11	7,5
K1297.13206	stainless steel	M6	32	16	22,5	11	9
K1297.14006	stainless steel	M6	40	20	28	14	9
K1297.14008	stainless steel	M8	40	20	28	14	12
K1297.14010	stainless steel	M10	40	20	28	14	15
K1297.15008	stainless steel	M8	50	25	35	17,5	12
K1297.15010	stainless steel	M10	50	25	35	17,5	15
K1297.16012	stainless steel	M12	60	30	37	18,5	18

