

## Clamp stops adjustable for slot profiles

### Item description/product images

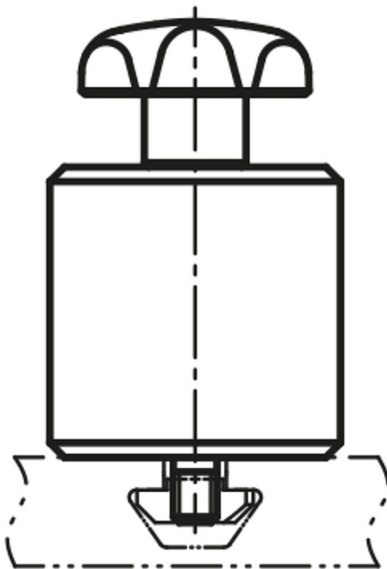

### Description

**Material:**

Body aluminium.

Other metal components steel.

Plastic components PA6.

**Version:**

Body natural tone anodised.

Other metal components trivalent blue passivated.

**Note:**

Sliding stop for profile systems type B, type I, and DIN 650 T-slots. Locked by turning the star grip. Sprung threaded pin ensures smooth sliding without tilting the slot key when loosened.

## Clamp stops adjustable for slot profiles

Item description/product images

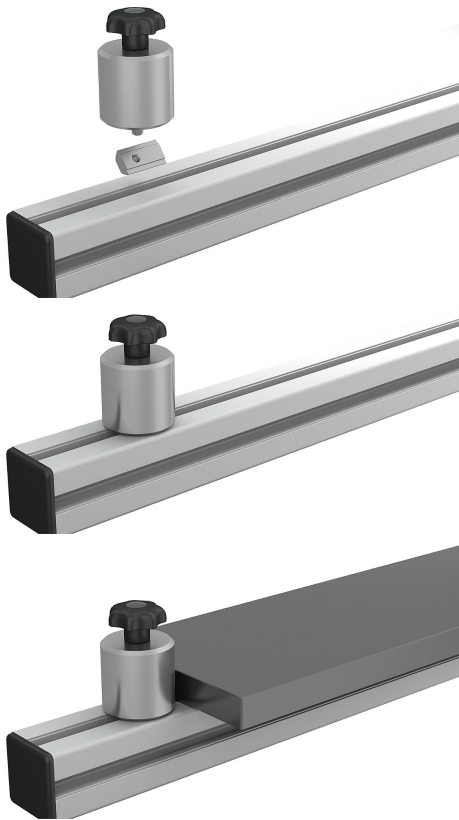

Drawings

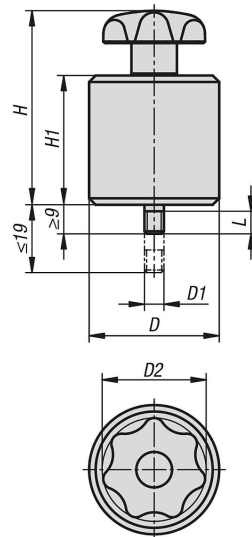

Overview of items

### Clamp stops adjustable for slot profiles

Order No.	D	D1	D2	H	H1	L
K1214.064040	40	M6	32	60	40	7

